

## Series 728 FireLock® Ball Valve

## PRODUCT DESCRIPTION

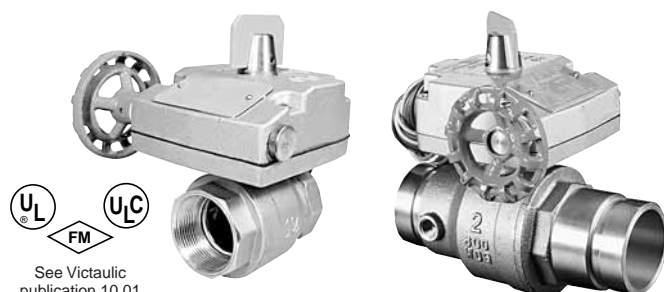

See Victaulic  
publication 10.01  
for details.

\*1/4" NPT available in 1 1/2" – 2"  
grooved version only

The Series 728 FireLock® valve is a standard port, end-entry valve that is UL/FM rated for 350 psi (2410 kPa) service in all sizes. Available with grooved or threaded ends (NPT), the valve body and gearbox are brass die cast. The ball is chrome plated brass with a brass stem. TFE seats aid ease of operation and provide a corrosion-free seat. The streamlined design provides excellent flow characteristics, which exceed UL Specification 1091 and FM Approval Standard 1112. The valve is approved for indoor and outdoor use.

## DIMENSIONS

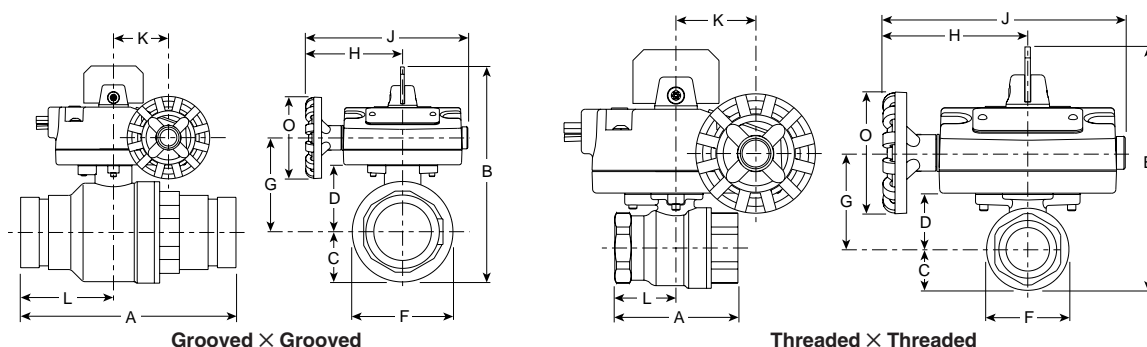

| SIZE<br>Nominal<br>Inches | Dimensions – Inches/millimeters |             |            |            |            |            |            |             |            |            |            | Aprx.<br>Wgt. Each<br>Lbs.<br>kg |
|---------------------------|---------------------------------|-------------|------------|------------|------------|------------|------------|-------------|------------|------------|------------|----------------------------------|
|                           | E to E<br>A                     | Height<br>B | C          | D          | F          | G          | H          | J           | K          | L          | O          |                                  |
| 1 Thd. X Thd.             | 2.84<br>72                      | 5.61<br>143 | 0.93<br>24 | 1.22<br>31 | 1.87<br>48 | 2.27<br>58 | 3.39<br>86 | 5.62<br>143 | 1.86<br>47 | 1.42<br>36 | 2.75<br>67 | 5.1<br>2.3                       |
| 1 1/4 Thd. X Thd.         | 3.31<br>84                      | 6.04<br>153 | 1.15<br>29 | 1.53<br>39 | 2.30<br>58 | 2.47<br>63 | 3.39<br>86 | 5.62<br>143 | 1.86<br>47 | 1.65<br>42 | 2.75<br>67 | 5.8<br>2.6                       |
| 1 1/2 Thd. X Thd.         | 3.66<br>92                      | 6.42<br>163 | 1.35<br>34 | 1.71<br>43 | 2.66<br>68 | 2.66<br>68 | 3.39<br>86 | 5.62<br>143 | 1.86<br>47 | 1.83<br>47 | 2.75<br>67 | 6.6<br>3.0                       |
| 2 Thd. X Thd.             | 4.33<br>110                     | 7.15<br>182 | 1.71<br>43 | 2.07<br>53 | 3.40<br>86 | 3.05<br>77 | 3.39<br>86 | 5.62<br>143 | 1.86<br>47 | 2.16<br>55 | 2.75<br>67 | 8.5<br>3.9                       |
| 1 1/4 Grv. X Grv.         | 7.25<br>184                     | 6.25<br>159 | 1.15<br>29 | 1.67<br>42 | 2.30<br>58 | 2.58<br>66 | 3.39<br>86 | 5.62<br>143 | 1.86<br>47 | 3.19<br>81 | 2.75<br>67 | 7.5<br>3.4                       |
| 1 1/2 Grv. X Grv.         | 7.25<br>184                     | 6.75<br>171 | 1.35<br>34 | 1.89<br>48 | 2.71<br>69 | 2.80<br>71 | 3.39<br>86 | 5.62<br>143 | 1.86<br>47 | 3.19<br>81 | 2.75<br>67 | 8.5<br>3.9                       |
| 2 Grv. X Grv.             | 7.25<br>184                     | 7.50<br>191 | 1.71<br>43 | 2.25<br>57 | 3.16<br>80 | 3.50<br>89 | 3.39<br>86 | 5.62<br>143 | 1.86<br>47 | 3.19<br>81 | 2.75<br>67 | 10.5<br>4.8                      |

## PERFORMANCE

| SIZE<br>Nominal Inches | Equivalent*<br>Feet/meters of Pipe | SIZE<br>Nominal Inches | Equivalent*<br>Feet/meters of Pipe |
|------------------------|------------------------------------|------------------------|------------------------------------|
| 1 Thread X Thread      | 0.5<br>0.2                         | 1 1/4 Groove X Groove  | 1.4<br>0.4                         |
| 1 1/4 Thread X Thread  | 1.0<br>0.3                         | 1 1/2 Groove X Groove  | 1.0<br>0.3                         |
| 1 1/2 Thread X Thread  | 1.7<br>0.5                         | 2 Groove X Groove      | 1.2<br>0.4                         |
| 2 Thread X Thread      | 0.5<br>0.2                         |                        |                                    |

\*Calculated using Hazen-Williams with C=120.

## SWITCH AND WIRING

### Supervisory Switch

The supervisory switch contains two, single pole, double throw, pre-wired switches.

Switches are rated:

- 10 amps @ 125 or 250 VAC/60 Hz
- 0.50 amps @ 125 VDC
- 0.25 amps @ 250 VDC
- 2.6 amps @ 24 VDC

### Supervisory Switch Wiring

#### A. Pre-wired Switches

(1) Switches supervise valve in "open" position

(2) One switch has two #18 MTW wires per terminal, which permit complete supervision of leads (refer to diagrams and note below). The second switch has one #18MTW wire per terminal. This double circuit provides flexibility to operate two electrical devices at separate locations, such as an indicating light and an audible alarm, in the area that the valve is installed.

(3) A #14MTW ground lead(green) is provided

- |           |    |
|-----------|----|
| Switch #1 | S1 |
| Switch #2 | S2 |
- 
- |    |   |                           |
|----|---|---------------------------|
| S1 | { | Normally Closed: (2) Blue |
|    |   | Normally Open: (2) Brown  |
|    |   | Common: (2) Yellow        |
- 
- |    |   |                           |
|----|---|---------------------------|
| S2 | { | Normally Closed:          |
|    |   | Blue with Orange Stripe   |
|    |   | Normally Open:            |
|    |   | Brown with Orange Stripe  |
|    |   | Common:                   |
|    |   | Yellow with Orange Stripe |

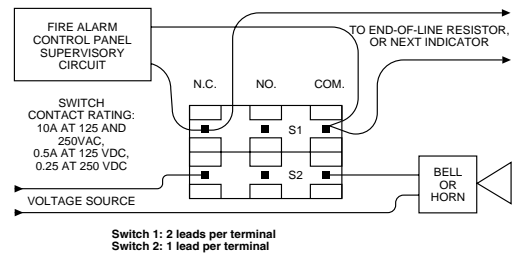
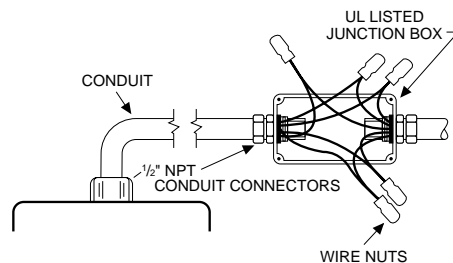

**NOTE:** The above diagram shows a connection between the common terminal (yellow-S1) and yellow-with-orange stripe-S2) and the normally closed terminal (blue-S1 and blue-with-orange stripe-S2). In this example, the indicator light and alarm will stay on until the valve is fully open. When the valve is fully open, the indicator light and alarm will go out. Cap off any unused wires (e.g. brown and brown with orange stripe).

## MATERIAL SPECIFICATIONS

**Valve Body:** Bronze ASTM B-584 Alloy 844

**Ball:** Chrome Plated Brass

**Stem:** 316 Stainless Steel

**Seat:** (TFE) tetrafluoroethylene

**Stem Nut:** Brass ASTM B-16 C36000

**Quadrant Gear:** 316 Stainless Steel

**Main Stem:** Brass ASTM B16 C36000

**Worm Gear:** AISI 1144 Steel

This product shall be manufactured by Victaulic Company. All products to be installed in accordance with current Victaulic installation/assembly instructions. Victaulic reserves the right to change product specifications, designs and standard equipment without notice and without incurring obligations.