

Plain End Piping System for High Density Polyethylene Pipe

PRODUCT DESCRIPTION

The Victaulic system – a series of couplings, flange adapters, HDPE-to-metal transition couplings, outlets and fittings – is the fastest and easiest way to join HDPE pipe. Victaulic HDPE products are designed to mechanically join HDPE (*high density polyethylene/polybutylene conforming to ASTM D-2447, D-3000, D-3035 or F-714, at ambient temperatures) pipe of wall thicknesses from SDR 32.5 to 7.3. Victaulic HDPE products have integral rows of gripping teeth in each side of the housing which bite into HDPE pipe around the entire circumference. This eliminates special heat fusion, solvent joining or special adapters. **Victaulic HDPE products are not intended for use on PVC pipe or other materials.** Victaulic lubricant should not be used with HDPE pipe.

Victaulic products for HDPE pipe are rated to pressures equal to the pipe with which they are used. The pipe manufacturer's listing is dependent upon wall thickness, pipe composition and temperature. Pipe tolerances shown in the charts are *at +70°F (+21°C) for rigid pipe with SDR of 20 or lower.



DIMENSIONS

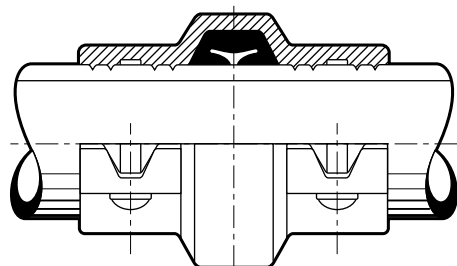

Exaggerated for clarity

Pipe – In./mm		Dimensions – In./mm			Pipe – In./mm		Dimensions – In./mm		
Nom. Dia.	Act. Out. Dia.	Outside Dia.		Max. Out of Round Tol.*	Nom. Dia.	Act. Out. Dia.	Outside Dia.		Max. Out of Round Tol.*
		Size	Tol. *				Size	Tol. *	
2	2.375	2.375	± 0.016	± 0.040	10	10.750	10.750	± 0.048	± 0.075
50	60,3	60,3	0,406	1,016	250	273,0	273,0	1,219	1,905
3	3.500	3.500	± 0.016	± 0.040	12	12.750	12.750	± 0.057	± 0.075
80	88,9	88,9	0,406	1,016	300	323,9	323,9	1,448	1,905
4	4.500	4.500	± 0.020	± 0.040	14 †	14.000	14.000	± 0.063	± 0.075
100	114,3	114,3	0,508	1,016	350	355,6	355,6	1,600	1,905
5	5.563	5.563	± 0.025	± 0.050	16	16.000	16.000	± 0.072	§
125	141,3	141,3	0,635	1,270	400	406,4	406,4	1,830	§
6	6.625	6.625	± 0.030	± 0.050	18	18.000	18.000	± 0.081	§
150	168,3	168,3	0,762	1,270	450	457,2	457,2	2,060	§
8	8.625	8.625	± 0.039	± 0.075	20	20.000	20.000	± 0.090	§
200	219,1	219,1	0,990	1,905	500	508,0	508,0	2,290	§

*At ambient temperatures.

§ See pipe manufacturer for maximum out of round tolerance.

† Contact Victaulic for special bolt/nut requirements.



It's fast

Just align the marked pipe ends, slide on the pressure-responsive gasket, and place both sections of the coupling over the pipe ends.



It's easy

No threading, grooving or fusing. Housings have tongue-and-recess mating for proper alignment of the coupling. Track head bolts allow tightening with one wrench.

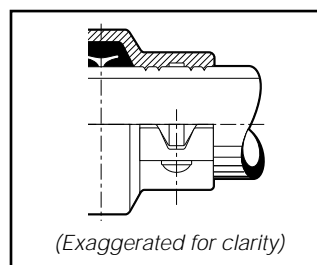

(Exaggerated for clarity)

It's rugged

Housings are cast of durable ductile iron. Sharp gripping teeth in each half of the housing bite into the pipe around the entire circumference.



It's reliable

Victaulic has laboratory and field tested the HDPE couplings and has found that the working pressure of the coupling meets or exceeds that of the pipe itself.

NOTE: ALWAYS REFER TO VICTAULIC I-900 INSTRUCTION HANDBOOK BEFORE ASSEMBLY.