

V27, K3.0/K3.5

Models V2714 and V2716

Residential

Pendent and Recessed Pendent

Quick Response

FOR RETROFIT ONLY

PRODUCT DESCRIPTION



Pendent

V2714
or
V2716

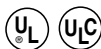

Recessed
Pendent

V2714
or
V2716

These Model V27 residential sprinklers are designed to meet the requirements of NFPA 13, 13D and 13R for residential use in a variety of room sizes, depending upon available operating pressure and room configuration. The design incorporates state-of-the-art, heat responsive, frangible glass bulb design (quick response) for prompt, precise operation.

The die cast frame is more streamlined and attractive than traditional sand cast frames. It is cast with a hex-shaped wrench boss to allow easy tightening from

many angles, reducing assembly effort. This sprinkler is available in various finishes to meet many design requirements.

Sprinkler Operation

The operating mechanism is a frangible glass bulb which contains a heat responsive liquid. During a fire, the ambient temperature rises causing the liquid in the bulb to expand. When the ambient temperature reaches the rated temperature of the sprinkler, the bulb shatters. As a result, the waterway is cleared of all sealing parts and water is discharged

towards the deflector. The deflector is designed to distribute the water in a pattern that is most effective in controlling the fire.

Coverage

Residential spray coverage up to 20 feet X 20 feet (6,1 m X 6,1 m) room sizes per NFPA.

NOTE: Residential sprinkler installations are covered by the obstruction rules for extended coverage sprinklers per the 1999 (or later) version of NFPA 13.

TECHNICAL SPECIFICATIONS

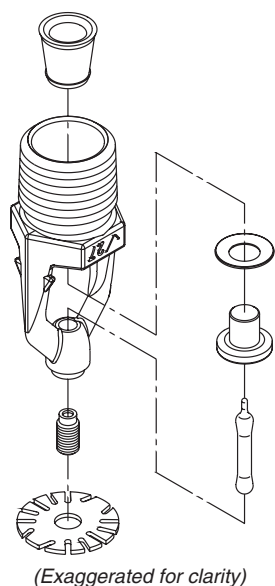

Models: V2714, V2716

Style: Pendent and Recessed Pendent

Nominal Orifice Size: 3/8" (10 mm)

K-Factor:

□ V2714 – 3.0 Imp. (4,3 S.I. ^) for room sizes up to 16' (4,9 m).

□ V2716 – 3.5 Imp. (5,0 S.I. ^) for room sizes 18' to 20' (5,5 and 6,1 m).

Nominal Thread Size: 1/2" NPT (15 mm)

Max. Working Pressure: 175 psi (1200 kPa)

Factory Hydrostatic Test: 100% @ 500 psi (3450 kPa)

Min. Operating Pressure: 7 psi (48 kPa)

Temperature Rating: See chart on page 2.

MATERIAL SPECIFICATIONS

Pendent Deflector:

UNS C51000

Bulb: Glass with glycerin solution.

Bulb Nominal Diameter: Quick Response: 3,0 mm

Load Screw: UNS C65100

Bushing: UNS C36000

Pip Cap: UNS C65100

Seal: Teflon* tape

Frame: Die cast brass 65-30

ACCESSORIES

Installation Wrench:

- Open End: V27
- Recessed: V38, V38-3

Sprinkler Finishes:

- Plain brass
- Chrome plated
- White painted**
- Custom painted**

For escutcheons, cabinets and other accessories refer to separate sheet.

NOTE: Weather resistant recessed escutcheon available upon request.

^ For K-Factor when pressure is measured in Bar, multiply S.I. units by 10.0.

*Teflon is a registered trademark of Dupont Co.

**UL Listed for corrosion resistance in all configurations.

VICTAULIC® IS AN ISO 9001 CERTIFIED COMPANY

Victaulic Company of America
Phone: 1-800-PICK-VIC (1-800-742-5842)
Fax: 610-250-8817
e-mail: pickvic@victaulic.com

Victaulic Company of Canada
Phone: 905-884-7444
Fax: 905-884-9774
e-mail: viccanada@victaulic.com

Victaulic Europe
Phone: 32-9-381-1500
Fax: 32-9-380-4438
e-mail: viceuro@victaulic.be

Victaulic America Latina
Phone: 610-559-3300
Fax: 610-559-3608
e-mail: vical@victaulic.com

Victaulic Asia Pacific
Phone: 65-6235-3035
Fax: 65-6235-0535
e-mail: vicap@victaulic.com

APPROVALS/LISTINGS

Model	Orifice Size Inches/mm	Nominal K-Factor Imperial S.I. [^]	Response	Deflector Type	Approved Temperature Ratings °F/°C ‡			
					UL	ULC	NYC/MEA†	CSFM §
V2714	7/16 12	3.0 4,3	Quick	Pendent	155 68	155 68	155 68	155 68
V2714	7/16 12	3.0 4,3	Quick	Recessed Pendent Up to 1/2" Adjustment	155 68	155 68	155 68	155 68
V2716	7/16 12	3.5 5,0	Quick	Pendent	155 68	155 68	155 68	155 68
V2716	7/16 12	3.5 5,0	Quick	Recessed Pendent Up to 1/2" Adjustment	155 68	155 68	155 68	155 68

‡ Listings and approval as of printing.

[^] For K-Factor when pressure is measured in Bar, multiply S.I. units by 10.0.

† MEA #62-99-E.

§ CSFM #7690-0531:112

RATINGS

All glass bulbs are rated for temperatures from -67°F (-55°C) up to those shown in adjacent table.

Sprinkler Temperature Classification	Victaulic Part Identification	Temperature – °F/°C		Glass Bulb Color
		Nominal Temperature Rating	Maximum Ambient Ceiling Temp.	
Ordinary	C	155 68	100 38	Red

ORDERING INFORMATION

Please specify the following when ordering:

☐ Sprinkler Model Number

☐ K-Factor

☐ Sprinkler Finish

☐ Style

☐ Thread Size

☐ Escutcheon Finish

☐ Temperature Rating

☐ Quantity

☐ Wrench Model Number

! WARNING



- Always read and understand installation, care, and maintenance instructions, supplied with each box of sprinklers, before proceeding with installation of any sprinklers.
 - Always wear safety glasses and foot protection.
 - Depressurize and drain the piping system before attempting to install, remove, or adjust any Victaulic piping products.
 - Installation rules, especially those governing obstruction, must be strictly followed.
 - Painting, plating, or any re-coating of sprinklers (other than that supplied by Victaulic) is not allowed.
- Failure to follow these instructions could result in serious personal injury and/or property damage.

The owner is responsible for maintaining the fire protection system and devices in proper operating condition. For minimum maintenance and inspection requirements, refer to the current National Fire Protection Association pamphlet that describes care and maintenance of sprinkler systems. In addition, the authority having jurisdiction may have additional maintenance, testing, and inspection requirements that must be followed.

If you need additional copies of this publication, or if you have any questions about the safe installation of this product, contact Victaulic World Headquarters, P.O. Box 31, Easton, Pennsylvania 18044-0031, 610-559-3300.

WARRANTY

Refer to the Warranty section of the current Price List or contact Victaulic for details.

DIMENSIONS

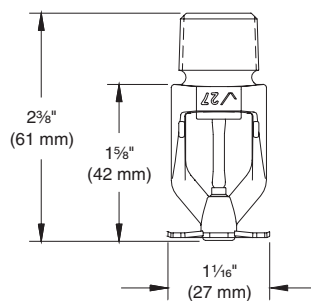

Standard Pendant – V2714

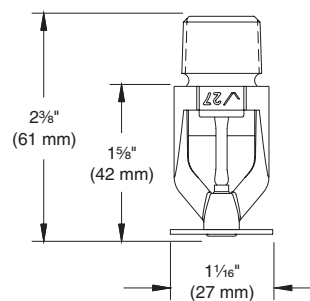

Standard Pendant – V2716

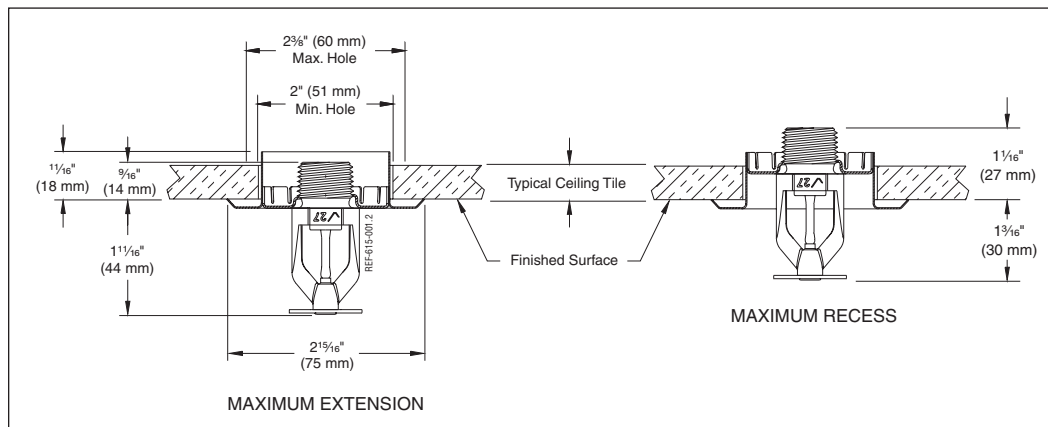

1/2" Adjustment
Recessed – V2714 or V2716
(Drawing not to scale)

AVAILABLE WRENCHES

	Open End	Recessed
V2714, V2716 – Pendant	V27	V38, V38-3
V2714, V2716 – Recessed Pendant	—	V38, V38-3

ROOM SIZE

Model	Room Size Feet/meters	Min. Installation Spacing Feet/meters	Nominal K-Factor Imperial S.I. [^]	Minimum Flow per Sprinkler GPM/LPM @ PSI/kPa	
				One Sprinkler Flowing	Multiple Sprinklers Flowing (per Sprinkler)
V2714	12 X 12 3,7 X 3,7	8.0 2.4	3.0 4.3	10 GPM @ 11.1 PSI 37,9 LPM @ 76,5 kPa	10 GPM @ 11.1 PSI 37,9 LPM @ 76,5 kPa
V2714	14 X 14 4,3 X 4,3	8.0 2.4	3.0 4.3	10 GPM @ 11.1 PSI 37,9 LPM @ 76,5 kPa	10 GPM @ 11.1 PSI 37,9 LPM @ 76,5 kPa
V2714	16 X 16 4,9 X 4,9	8.0 2.4	3.0 4.3	11 GPM @ 13.5 PSI 41,6 LPM @ 93,1 kPa	11 GPM @ 13.5 PSI 41,6 LPM @ 93,1 kPa
V2716	18 X 18 5,5 X 5,5	9.0 2.7	3.5 5.0	13 GPM @ 13.8 PSI 49,2 LPM @ 95,2 kPa	13 GPM @ 13.8 PSI 49,2 LPM @ 95,2 kPa
V2716	20 X 20 6,1 X 6,1	9.0 2.7	3.5 5.0	16 GPM @ 20.9 PSI 60,5 LPM @ 144,1 kPa	16 GPM @ 20.9 PSI 60,5 LPM @ 144,1 kPa

[^] For K-Factor when pressure is measured in Bar, multiply S.I. units by 10.0.

NOMINAL WETTING PATTERNS

MODEL V2714
K3.0 RESIDENTIAL PENDENT AND RECESSED PENDENT
10 GPM (37,9 LPM)

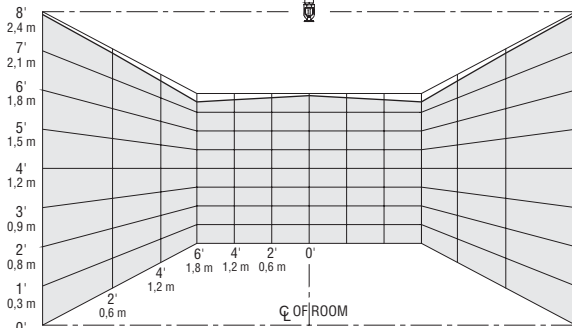

NOMINAL WETTING PATTERN
12' X 12' COVERAGE AREA

MODEL V2714
K3.0 RESIDENTIAL PENDENT AND RECESSED PENDENT
10 GPM (37,9 LPM)

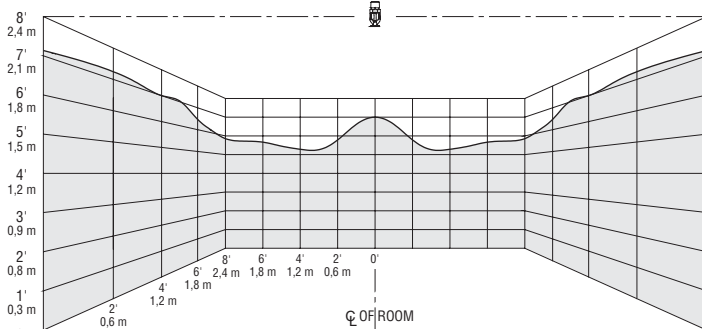

NOMINAL WETTING PATTERN
16' X 16' COVERAGE AREA

MODEL V2716
K3.5 RESIDENTIAL PENDENT AND RECESSED PENDENT
13 GPM (49,2 LPM)

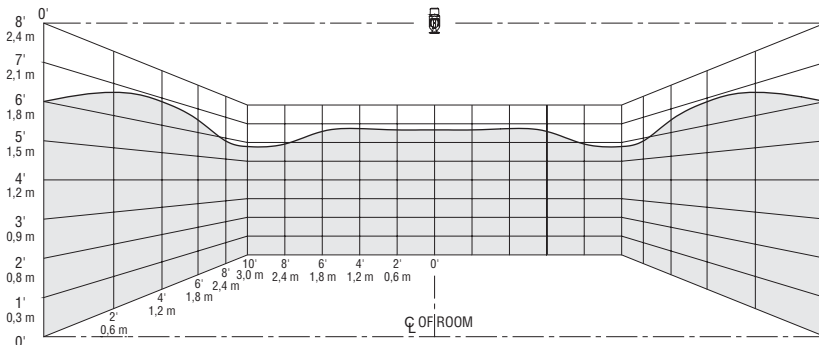

NOMINAL WETTING PATTERN
20' X 20' COVERAGE AREA

MODEL V2714
K3.0 RESIDENTIAL PENDENT AND RECESSED PENDENT
10 GPM (37,9 LPM)

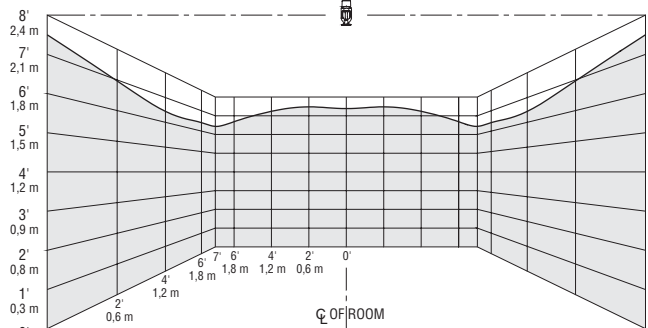

NOMINAL WETTING PATTERN
14' X 14' COVERAGE AREA

MODEL V2716
K3.5 RESIDENTIAL PENDENT AND RECESSED PENDENT
13 GPM (49,2 LPM)

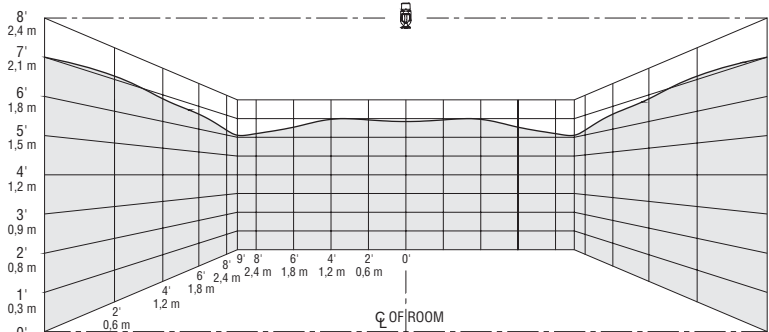

NOMINAL WETTING PATTERN
18' X 18' COVERAGE AREA

NOTES:

1. Data shown is approximate and can vary due to differences in installation.
2. These graphs illustrate approximate trajectories, floor-wetting, and wall-wetting patterns for these specific Victaulic FireLock Automatic Sprinklers. They are provided as information for guidance in avoiding obstructions to sprinklers and should not be used as minimum sprinkler spacing rules for installation. Refer to the appropriate NFPA National Fire Code or the Authority Having Jurisdiction for specific information regarding obstructions, spacing limitations and area of coverage requirements. Failure to follow these guidelines could adversely affect the performance of the sprinkler and will void all Listings, Approvals and Warranties.
3. All patterns are symmetric to waterway.

This product shall be manufactured by Victaulic Company. All products to be installed in accordance with current Victaulic installation/assembly instructions. Victaulic reserves the right to change product specifications, designs and standard equipment without notice and without incurring obligations.